

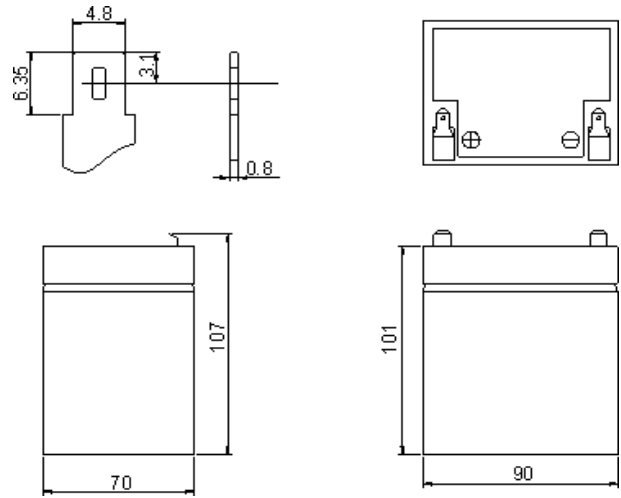

• **Specifications**

Nominal Voltage		12V
Rated Capacity		4Ah
Dimensions	Total Height	4.21 inches (107mm)
	Height	3.98 inches (101mm)
	Length	3.54 inches (90mm)
	Width	2.76 inches (70mm)
Approximate Weight		2.90 lbs. (1.32kg)



• **Characteristic**

Capacity 77°F(25°C)	20h rate (0.2A)	4Ah
	10h rate (0.4A)	4Ah
	5h rate (0.72A)	3.6Ah
	1h rate (3.06A)	3.06Ah
	15 min rate (8.28A)	2.07Ah
Internal Resistance	Full Charged Battery 77°F(25°C)	48mΩ
Capacity Affected by Temperature (20h rate)	104°F(40°C)	102%
	77°F(25°C)	100%
	32°F(0°C)	85%
	5°F(-15°C)	65%
Self-Discharge 68°F(20°C) (Capacity after)	3 month storage	90%
	6 month storage	80%
	12 month storage	60%
Max. Discharge Current 77°F(25°C)	67.5A(5s)	
Terminal	T1	
Charge (Constant Voltage, 25°C)	Cycle	14.5~14.9V(-24mV/°C) max. current: 1.6A
	Float	13.6~13.8V(-18mV/°C)

DISCHARGE CHARACTERISTICS AT 25°C (77°F) *

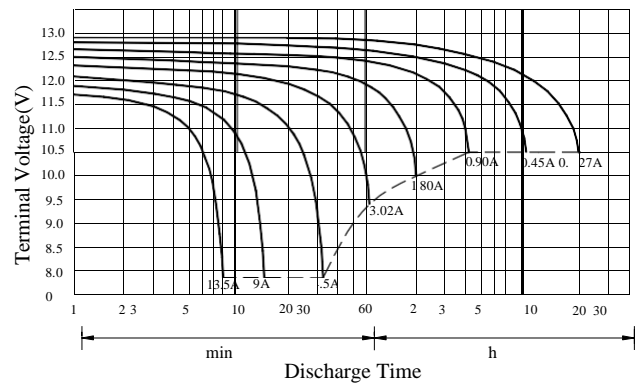

DISCHARGE CURRENT V'S TIME 25°C (77°F)

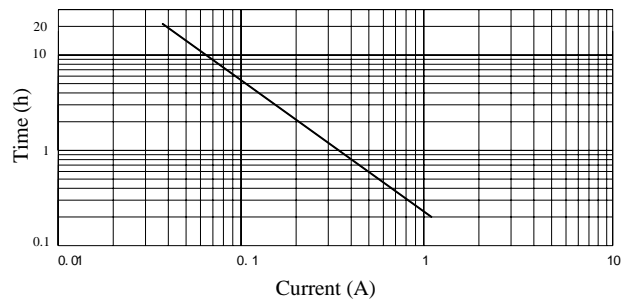

*The above data are of average values, and can be obtained within 3 charge/discharge cycles. These are not minimum values.

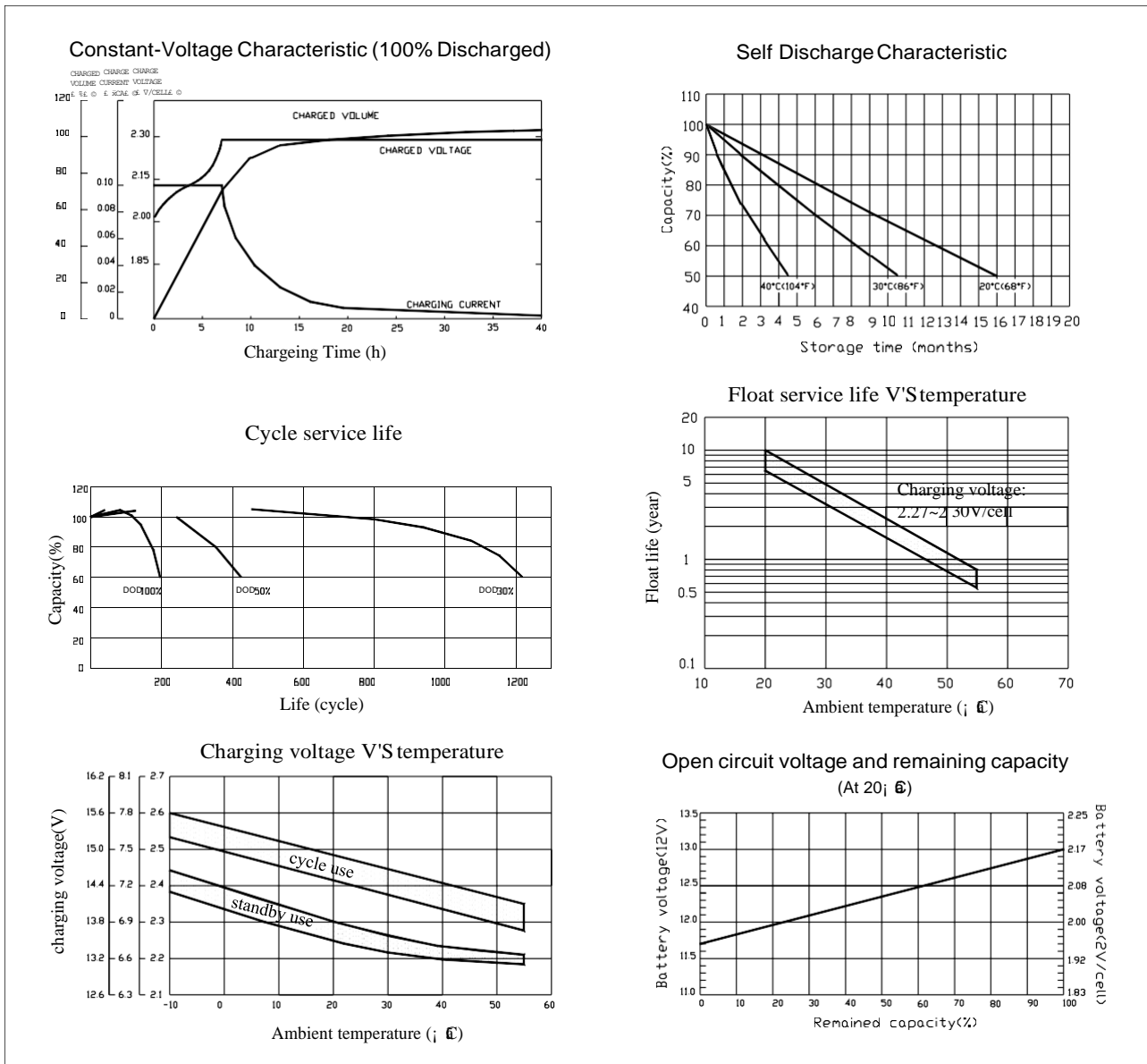

- **Constant wattage discharge at stipulated cut-off voltages: Watt/Ah/Cell at 25°C**

Final voltage (V/cell)	5m	10m	15m	30m	45m	1h	2h	3h	5h
1.60V	28.00	18.00	13.80	9.30	6.71	5.40	3.24	2.19	1.44
1.65V	27.20	17.60	13.60	9.15	6.62	5.37	3.21	2.16	1.44
1.70V	27.00	17.40	13.40	8.55	6.40	5.27	3.15	2.05	1.42
1.75V	25.70	17.30	13.30	8.28	6.18	5.18	3.07	1.98	1.40
1.80V	23.60	16.80	12.40	7.89	5.93	4.89	2.96	1.90	1.32